

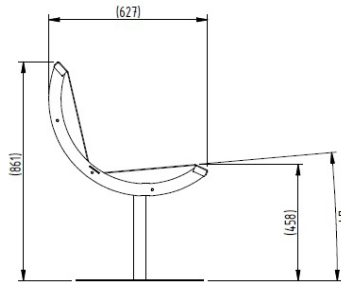

Rockingham Seat 1800mm

Galvanised, Galvanised & Colour or Stainless

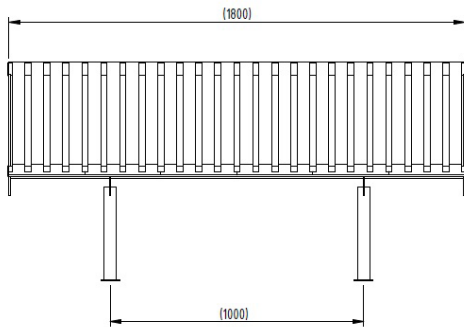

Sleek and stylish, the Rockingham Seat from AUTOPA is ideal for busy public areas. The AUTOPA Rockingham Seat has been designed to withstand the toughest conditions and to look good for years with only minimal maintenance.

The Rockingham Seat is supplied in galvanised mild steel, or stainless steel. Galvanised and powder coated is an optional extra (RAL number must be stated at time of order).

Available concrete in or bolt down.



Part Number	Description	Weight (kg)
138 117 010	Rockingham Seat, Galvanised - Concrete In	52kg
138 117 011	Rockingham Seat, Galvanised & Colour - Concrete In	52kg
138 117 016	Rockingham Seat, Stainless Steel Grade 304 - Concrete In	53kg
138 117 010F	Rockingham Seat, Galvanised - Bolt Down	52kg
138 117 011F	Rockingham Seat, Galvanised & Colour - Bolt Down	52kg
138 117 016F	Rockingham Seat, Stainless Steel Grade 304 - Bolt Down	53kg

Product details

- 1800mm x 627mm (length x width)
- 458mm (seat height)
- Galvanised/galvanised & coated finish complete with plastic end caps
- Concrete in 300mm (below ground)
- Flange plate – 500mm x 75mm x 5mm
- Each bench requires 8 x 12mm bolts

Installation & use

Supplied fully welded for easy installation on site.

Bolt down versions require bolting to an appropriate concrete surface by means of 12mm bolts.

Concrete in versions require an excavated hole for installation.

Clean off any concrete splashes after installation. Always allow sufficient time for concrete to cure before usage.

These products are guaranteed for 12 months (if installed and used correctly).



www.autopa.co.uk
+44 (0)1788 550556

AUTOPA Limited
Cottage Leap, Rugby, Warwickshire CV21 3XP

